

APPROVED BY _____

DATE _____

PAINT CODE _____

PW7 WHITE

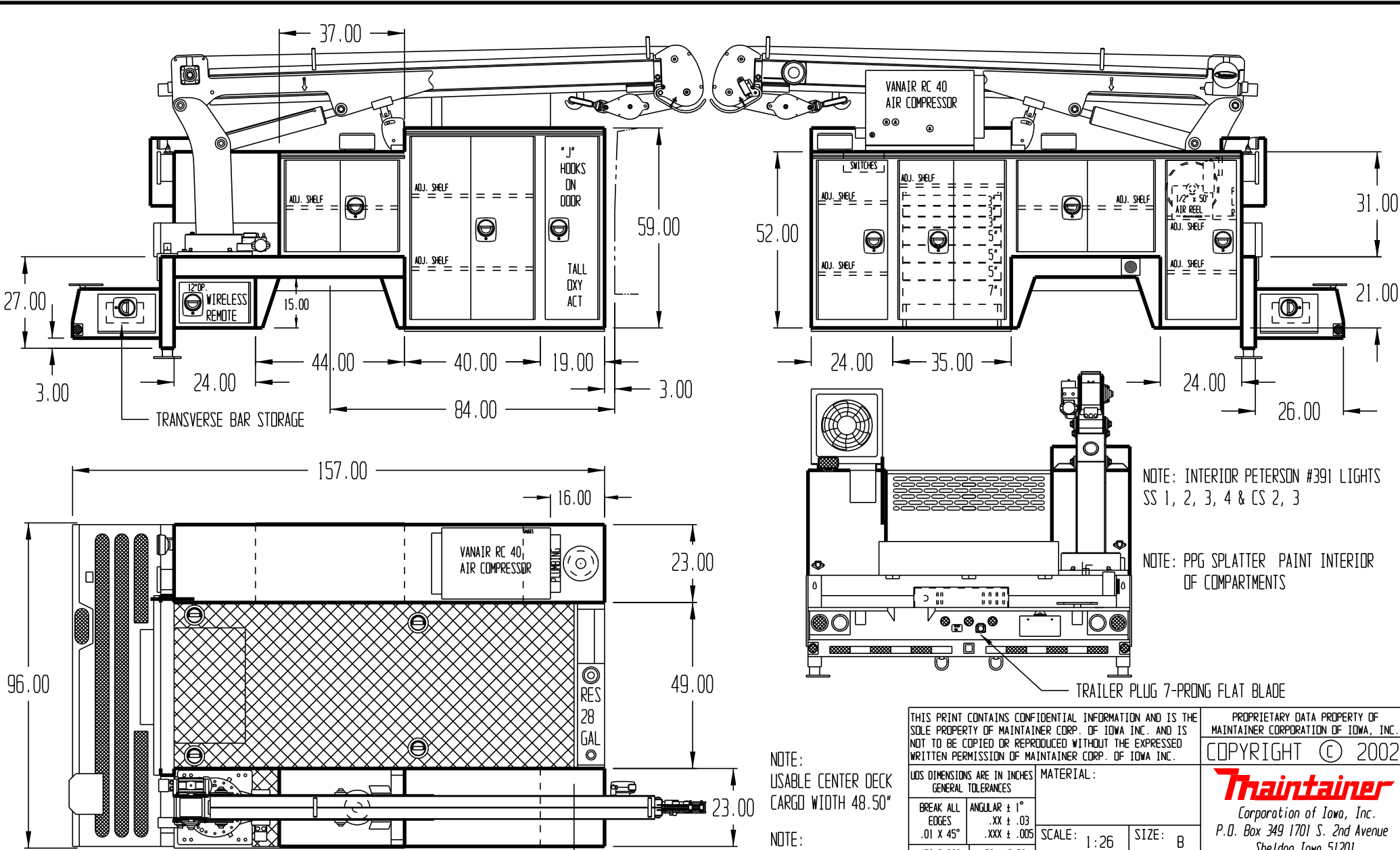

NOTE: INTERIOR PETERSON #391 LIGHTS
SS 1, 2, 3, 4 & CS 2, 3

NOTE: PPG SPLATTER PAINT INTERIOR
OF COMPARTMENTS

NOTE: 20 GALLON AIR STORAGE
MOUNTED IN CHASSIS FRAME

SLOTTED BULKHEAD 9.00

NOTE:
USABLE CENTER DECK
CARGO WIDTH 48.50"

NOTE:
10" TALL SUBFRAME
WITH FORMED CROSS
MEMBER ANGLES

THIS PRINT CONTAINS CONFIDENTIAL INFORMATION AND IS THE SOLE PROPERTY OF MAINTAINER CORP. OF IOWA INC. AND IS NOT TO BE COPIED OR REPRODUCED WITHOUT THE EXPRESSED WRITTEN PERMISSION OF MAINTAINER CORP. OF IOWA INC.		PROPRIETARY DATA PROPERTY OF MAINTAINER CORPORATION OF IOWA, INC. COPYRIGHT © 2002	
LDS DIMENSIONS ARE IN INCHES GENERAL TOLERANCES		MATERIAL:	
BREAK ALL EDGES .01 X 45°	ANGULAR ± 1° .XX ± .03 .XXX ± .005	SCALE: 1:26	SIZE: B
LDS RADI	LDS ANGLES	DRAWING NUMBER: DA139-DA141	OFTM. ADB DATE: 5/30/12
MADE IN THE USA		H6520TT-1-084 HAG / STOCK - RAM 5500	

Maintainer
Corporation of Iowa, Inc.
P.O. Box 349 1701 S. 2nd Avenue
Sheldon, Iowa 51201